

# Bluetooth APP operating instructions

## APP interface Description

Use the QR code below or search for and download the "Power Station Manager" app from your mobile app store.



After installing the APP, open it directly, and allow all involved in it. Go to the home page and wait for adding devices; Figure 1 below

## Bluetooth connection instructions

Conditions: The Bluetooth connection of the user's mobile phone should be kept within 30 meters, and the mobile phone should not be too far away from the power station when connecting, prevents unsuccessful connections.

1. Turn on the power station with Bluetooth function and SOC (power display) is  $\geq 0\%$ , press and hold the DC and the LED button at the same time for more than 5 seconds. Until the machine screen displays the following Figure 2 icon flashes, it can be Bluetooth connected to your phone.

2. Turn on Bluetooth, click the device on the home page of the APP, and the page of Bluetooth and WIFI will pop up.

3. Enter the mobile phone authorization, pop-up to allow Bluetooth or WIFI to be turned on, select Allow, after opening, wait to search for nearby devices in the distribution network state, and click Add, as shown in Figure 3.

## Select connection control mode

### Bluetooth close range control mode

Mobile phone distance with APP function of the power station (within 30 meters), and in the case of the machine without shielding, close up individual Bluetooth connection mode, click skip to switch the Bluetooth connection mode, as shown in Figure 4 below

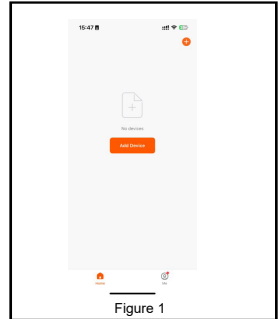

Figure 1

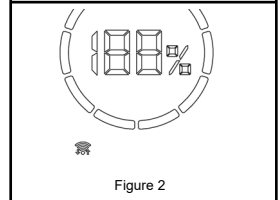

Figure 2

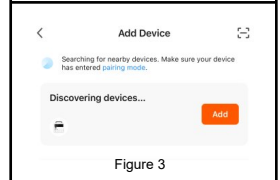

Figure 3

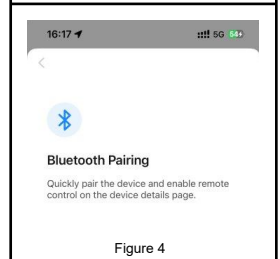

Figure 4

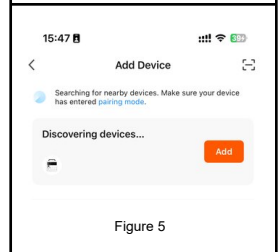

Figure 5

- Click the next step as shown in Figure 5 for Bluetooth connection.
- After the connection, the connection success message as shown in Figure 6 will pop up. Click Finish, indicating that the Bluetooth connection is successful.
- After the connection is successful, the interface shown in Figure 9 will be automatically displayed. Successfully connected to this Bluetooth control mode

Note that users should keep Bluetooth and WiFi enabled on their phones for optimal connectivity.

## WiFi remote control mode

You can switch to WiFi remote control mode after connecting Bluetooth close mode successfully. You can also direct WiFi remote control connection.(Mode 2 remote control must be within the range of WiFi coverage)

- First of all, WiFi must be turned on when Bluetooth is turned on, and the WiFi that can be connected to the Internet, as shown in Figure 7 below.
- Directly click Next to wait for the distribution network, the distribution mode is the same as the Bluetooth proximity control mode, until the connection is successful, as shown in above Figure 5 and Figure 6, the WiFi Bluetooth remote control mode is successfully connected. Just disconnect WiFi and wait about 1 minute to switch back to Bluetooth proximity control mode.

## Two connection modes switch

### Bluetooth connection Switch /WiFi remote connection

- After the Bluetooth connection is successful, you can also switch the WiFi connection, turn on the WiFi, and successfully connect the WiFi that can be connected to the normal Internet, and then the remote control can be successfully connected, as shown in Figure 6 , back to the home page , the remote connection switch is successful.
- After switching the remote control successfully, return to the home page to refresh, disconnect WiFi and Bluetooth directly using the data network can also achieve remote control. After the switch is successful, even if you exit the smart life APP, as long as you do not delete the connected device, re-enter the APP is still connected.

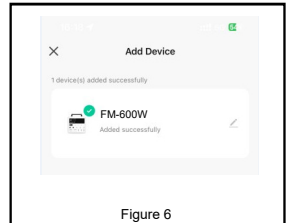

Figure 6

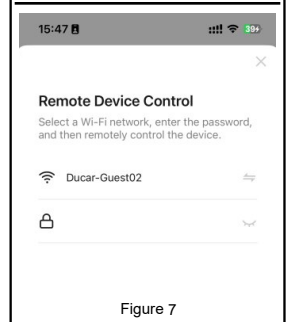

Figure 7

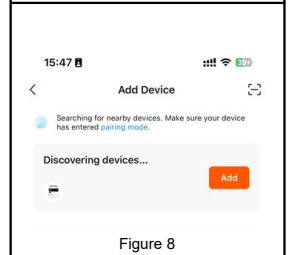

Figure 8

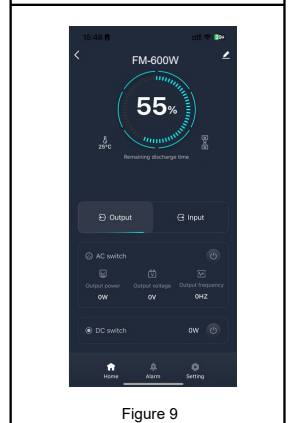

Figure 9

## Display illustrate

### WIFI icon display

If the user turns on the power station device with SOC $\geq$ 0% and no WIFI icon is displayed, press and hold the DC and the LED button at the same time for more than 5 seconds activate the WIFI icon. Wait for the WIFI icon on the panel to start blinking, and then connect your phone's Bluetooth.

- If the WIFI icon flashes after the device is turned on, it means the device is available for connection, and you can directly enter the APP to connect the device.
- If the WIFI icon continues to light up when the device is turned on, it indicates that someone has connected to the device. Press and hold the DC and the LED button at the same time for more than 5 seconds. Reset and reconnect Bluetooth.

### Connection success display

The user follows the above connection instructions and the WIFI icon on the power station screen lights up, the connection is successful. Connect APP must have Bluetooth on to connect.

#### 5.3 SOC Display (Power Display)

After the connection is successful, the SOC power and power station screen display the same number (including the color dot outside the SOC), when the SOC $\leq$ 10, the outer ring on the APP turns red, and the outer ring on SOC > 10 turns blue, as shown in Figure 10 below.

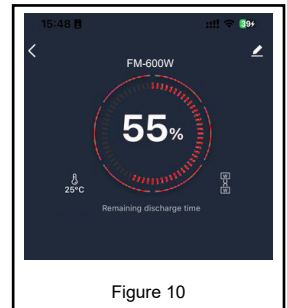

Figure 10

### Note

1. After the device is triggered for network configuration, the wireless communication icon on the device's LCD will flash for 3 minutes. If the network configuration is not completed within 3 minutes, the icon will no longer be displayed, and you will need to trigger the network configuration button again.
2. If the device cannot be found in the app after opening it, please confirm whether the device is connected by another app and whether the WIFI and Bluetooth switches are turned on. If the device is connected by another app, you need to re-trigger the device to enter the network configuration state. If the WIFI and Bluetooth switches are not turned on, you need to enter the phone settings interface to turn on the WIFI and Bluetooth switches, and then enter the app to search.
3. If the energy storage device can be found but cannot be connected or the connection is unstable after opening the app, please confirm whether the phone is close enough to the device in the Bluetooth near-field connection mode, and whether the cellular communication signal is stable in the IOT remote connection mode.
4. If the content displayed on the LCD after the app connects to the device is out of sync with the app, please confirm whether the cellular communication signal is stable.